

Plot 7

4/5 bedroom Home

Second Floor			
Master / Guest Suite or as optioned*	4400mm x 10000mm	14'5" x 32'9"	

First Floor			
Bedroom 1 + En-suite	4400mm x 5400mm	14'5" x 17'9"	
Bedroom 2	2600mm x 4600mm	8'6" x 15'2"	

Ground Floor			
Lounge	4400mm x 4300mm	14'5" x 14'1"	
Bathroom	2600mm x 1700mm	8'6" x 5'6"	
Bedroom 3	2600mm x 4000mm	8'6" x 13'1"	

Lower Ground Floor			
Kitchen / Diner	4400mm x 6000mm	14'5" x 19'8"	
Playroom / Study	2600mm x 4000mm	8'6" x 13'1"	
Utility	1800mm x 2000mm	5'10" x 6'6"	

Basement			
Basement / Cellar	4400mm x 10000mm	14'5" x 32'9"	

Size of property: 219.99 Sq.m (2368 Sq.ft) approx

All measurements given are approximate, for further details please contact our Agents. The dimensions given are done so in good faith and before construction has commenced. They are approximate and for guidance purposes only and not included to be used for furniture or appliance space. Purchasers are strongly advised to confirm actual dimensions when the property is nearing completion.

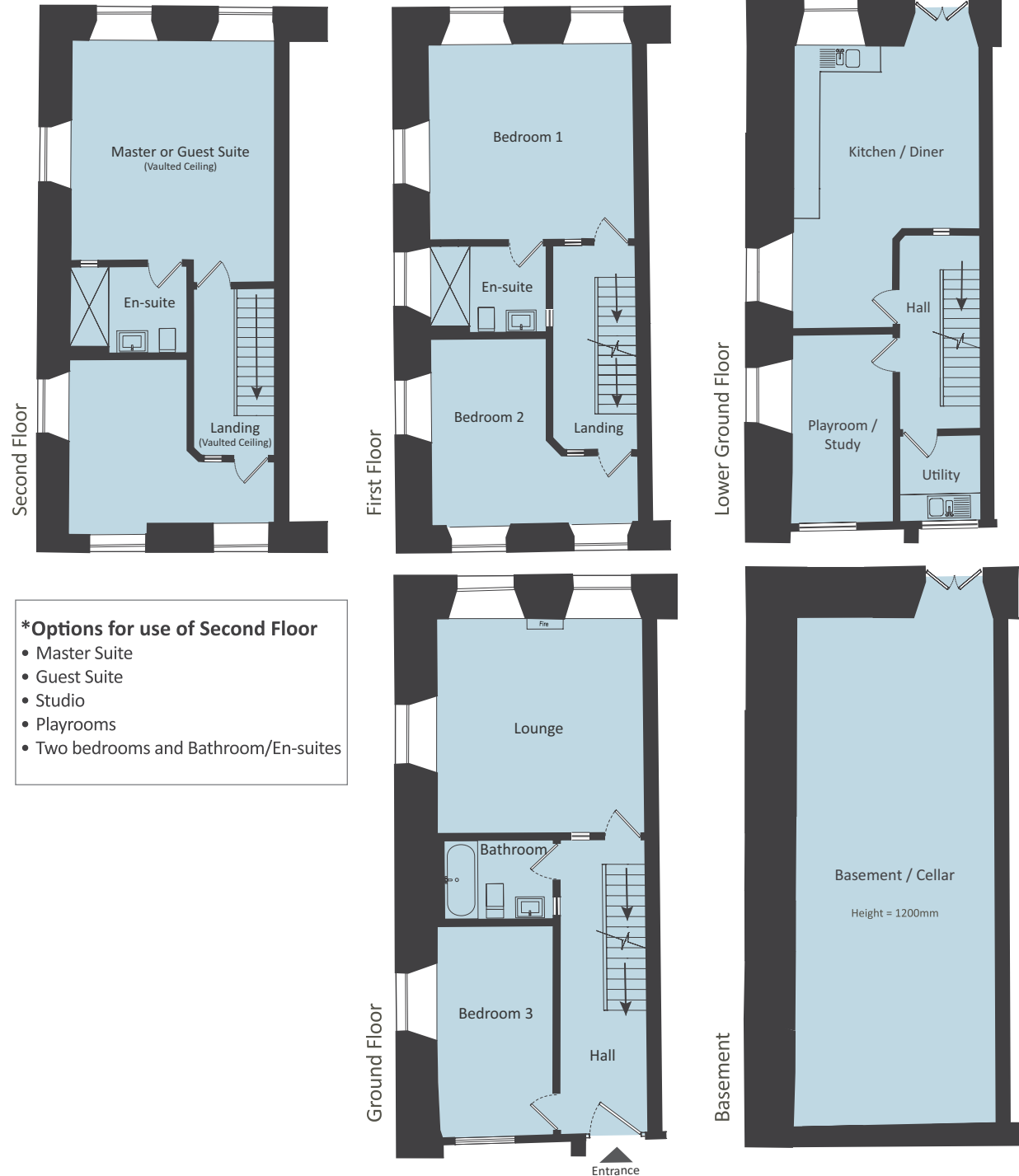

***Options for use of Second Floor**

- Master Suite
- Guest Suite
- Studio
- Playrooms
- Two bedrooms and Bathroom/En-suites